



# LIGHTING DESIGNERS TOOL OF CHOICE

Strategic Group products which have a design or performance "edge" as well as outstanding redeeming qualities, application or uniqueness.



### LED Power Output to 1920lms/M

- Includes a "new" generation of 3W PowerLED's or SMD sidetapes.
- The new LED packages are currently out performing traditional LED's, providing a new way forward in output, reliability and lower cost.

[ Halo-pod will be continually updated with the latest best performing LED's. For further guidance contact our technical support desk.]



Seamless Lighting

## \*ACOUSTIC SOUND DAMPENING

.....hear the difference .....

\* HALO-POD has acoustic sound absorption to ISO 11654.

**Mix & Match** HALO-POD™ - use PowerLED's or SideLED tape . . . combine circuits, products or white with colour in the same pod.



**Dimmable, Programmable, Colour Change** Full DMX control, Colour Wheel Wall Switch , 0-10V slide dimming, all with ease . .



**Add extra Feature Lighting to your HALO-POD** Ready installed - all superior quality with low cost. All LED technology . . . . .



**STRATEGIC LIGHTING GROUP**  
LIGHTING WITH PURPOSE

## ACOUSTIC HALO-POD LED 230V

- single colour & RGB full colour change
- MacAdam colour consistency to 1 Ellipse - 100K.

### Product Summary

- Discrete indirect functional lighting or reduced output feature lighting
- Use as main room centre focus lighting or as a halo feature.
- Spot & shadow free lighting.

### Applications

- As the main ambient light source or as an ornate room decorative feature.
- Or to delineate interior arrangements, for example sited above;
  - dining / conference tables
  - kitchen islands
  - breakfast bars
  - reception desks
  - meeting room tables
- Ideal ;
  - above hotel beds,
  - or as bed canopies
  - function rooms
  - above bars
  - in restaurants
  - reception areas



### Full Control

- Circuit dimmable in 0-10V or DALI
- Full Colour Change RGB
- DMX 512 programming
- or simple colour scroll wheel wall switches.

### Choice of Shapes

- HALO-POD is available in popular shapes & sizes to enhance rooms and interior features.
- Popular shapes include Ellipses, Squares, Rectangles & Circles, but we also offer others, such as Flat-end Ellipses, Plectrums & Polygons.
- Custom shapes are available for large volumes or contract projects on request.

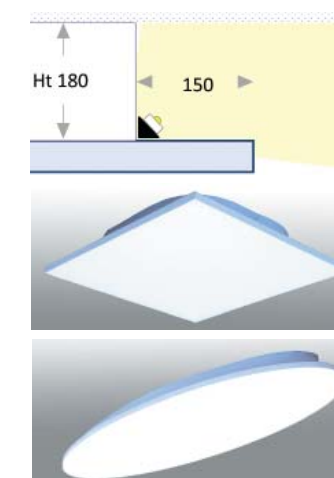
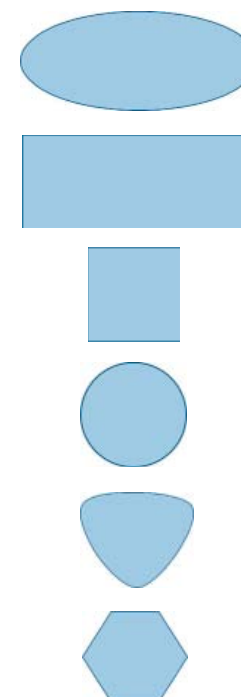

optional extra feature lighting .....  
**FIBRE OPTIC STARS**

**& SPOTLIGHTS**



HALO-POD features full accreditation for .....  
**ACOUSTIC SOUND DAMPENING**

## ACOUSTIC LIGHTING PODS

..... see and hear the difference .....  
 \* acoustic sound absorption to ISO 11654.

### Powerful LED Output

- Select optional LED power levels, optimise output, optimise capital costs.

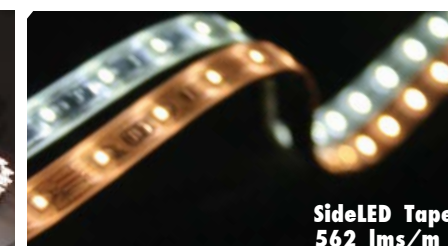
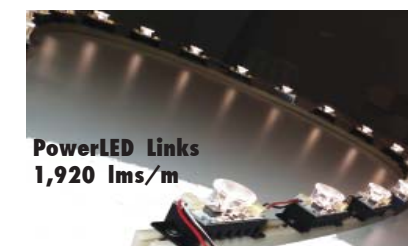

- Available in PowerLED [ with or without Optics ]
  - Pitch 100mm = 1,920 lms / metre
  - Pitch 150mm = 1,300 lms / metre
  - Pitch 200mm = 960 lms / metre

- Available in SideLED tape to IP66 [ 120° ]
  - Pitch 28mm = 273 lms / metre
  - Pitch 8mm = 562 lms / metre

### Fast easy mounting

- Fast on-site installation.
- Pre-assembled pods with minimal site works.
- Bolt on mounting bracket.
- Quick-fit plug connectors.
- Integral gear & control interfaces
- Suitable for ceiling or wall mounting.

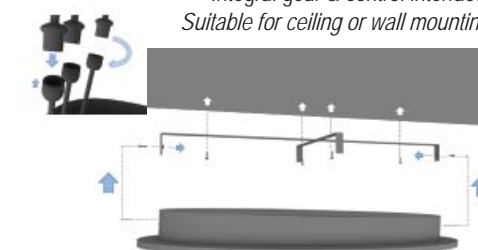



# ACOUSTIC HALO-POD LED<sub>230V</sub>

single colour & RGB full colour change



**LIGHTING DESIGNERS TOOL OF CHOICE**  
 Colour Consistency to :  
 1 MacAdam Ellipse <100K  
 IP20 IP66

## Performance

- Lamp Type** : PowerLED or SMD LED's
- LED Qty** : PowerLED : Pitch 100,150,200mm  
SideTapeLED : Pitch 8.3 - 28mm
- Lamp Source** : Power in SSC® Z5  
SideTapeLED - OSRAM Duris SMD
- Lumens** : Typical 64 lms/Watt [ 3000K White ]
- Lamp CRI** : Ra >90 white [ see nm for RGB ]
- Colour Olty** : Binning 1 MacAdam Ellipse 100K
- LED Life** : min.50,000hrs plus
- Optic Beams** : PowerLED : Without Optic = 120°  
Optics in ; Wall Wash 15x60°,  
Medium-Wide 40°, Medium 25°  
or Narrow 10°  
SideTapeLED : Side Asymm 106°

## Electrical Data

- Voltage** : 230V [ integral gear ]
- Load Watt** : PowerLED White : 15 - 30W/m  
PowerLED RGB : 27 - 53W/m  
SideLED Tape White : 4.3 - 9.7W/m  
SideLED Tape RGB : 6W/m
- Integral Gear** : On-board Drivers & Interfaces
- Configuration** : Dimmable or RGB full colour change
- Data Protocol** : DALI, 0-10V & DMX 512,  
or ColourWheel Switch Plate

## Construction & Finishes

- Body shape of engineered light-weight acoustic sound boards to ISO 11654 made from glass wool wrapped in an enduro textured coat and painted White (S0500N), Cream or Mocha
- PowerLED option with PCB on extruded anodised aluminium heatsink pre-mounted on a black PVC channel.
- SideTapeLED with PCB in engineered PVC polymer continuum in white & clear pre-mounted on a clear polymer PETG clip u-channel.

## Connectivity

- For full 230V connectivity with all integral gear & control line cables.
- Circuits for Whites with 4-core to enable dimmability with L, N & 0-10V or DALI pair
- Circuits for RGB with 5-core to enable L, N & RGB signal inputs.

## Description

A professional architectural finished pod available in a choice of shapes for fast easy direct-fixing to ceilings (or walls) with a 180mm rebate for purpose made indirect halo lighting in variable output LED technology.

Ideal as a room's main primary ambient light source, as a centre peice or as decorative feature lighting. Also in applications for delineating room layouts, interior areas & reinforcing features such as reception desks, meeting room tables, dining tables, hotel beds, bed canopies, breakfast bars and kitchen islands.

Additional feature lighting can be added such as fibre optic stars or perimeter adjustable LED spots [ as standard - see page 13 overleaf ]. Can be customised by adding other standard range downlights or drop spot lights. Other lighting designers "wish-list" items may be accomodated subject to evaluation - please consult our technical dept.

Shadow free lighting from warm 2700K to cool 6500K. RGB Tri-chip technology for full colour change. Dual circuitary possible for mix & match LED types, offered also in dynamic-white control [ DWCS ] or mixed White & RGB formats side by side, all at the flick of a switch. Take control via dimming in 0-10V or DALI & RGB in DMX 512. programmable or via a simple wall switch colour scroll wheel.

HALP-POD all with sound dampening benefits to ISO 11654 acoustic standard.

## Mounting

- Mounting is via screw-fix ceiling (or wall) brackets with bolt lock on to the POD.
- Factory assembled with only minor site works and connection using quick male-female connectors to live mains power & signal cables.

## PowerLED Colours

- Extra Warm White - 2700K - CRI > 90%
- Warm White - 3000K - CRI > 90%
- Intmd White - 4000K - CRI > 90%
- Cool White - 5300K - CRI > 80%
- Other single colours on request [ Blue, Red, Green etc.].
- RGB Colour Change

**LED DEDICATION** CONSTANT VOLTAGE

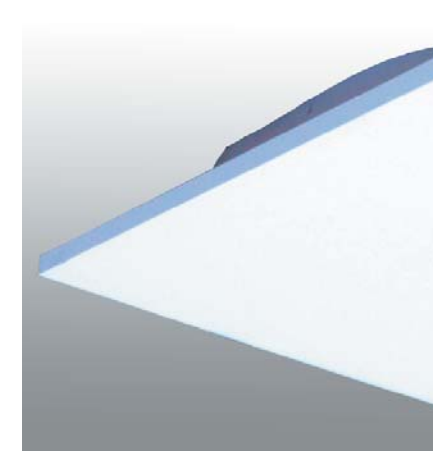

## Halo-pod Shapes [ typically 1.2 - 2.4 metres in length ]

HALO-POD is a 40mm thick light-weight board, constructed of compressed glass wool with a durable outer-coat, dropped or off-set 180mm off the ceiling (or wall) line. [ complying with acoustic sound dampening to ISO11654 ]. Used with a rebated 150mm all metal 'skirt' enabling discrete mounting of the linear LED lighting [ shown over-pages ]. All factory pre-assembled for minimal site works. Finished in matt white as standard or in NCS colour Cream or Mocha. Other finishes on request - subject to minimum order quantities.

### Ellipse 2400x1000mm [Lighting L=4.6metres] 7.5Kg

○ HPEW	E - Ellipse	White - S0550N	2400 x 1000mm	Lit Length = 4.6m
● HPEC	E - Ellipse	Cream S1505-Y	2400 x 1000mm	Lit Length = 4.6m
● HPEM	E - Ellipse	Mocha - S2005-Y	2400 x 1000mm	Lit Length = 4.6m
⊕ HPECUS	E - Ellipse	Custom Paint	2400 x 1000mm	Lit Length = 4.6m

### Flat End Ellipse 2000x1000mm [Lighting L=4.1metres] 6.5Kg

○ HPFEW	FE -Flat Ellipse	White - S0550N	2000 x 1000mm	Lit Length = 4.1m
● HPFEC	FE -Flat Ellipse	Cream S1505-Y	2000 x 1000mm	Lit Length = 4.1m
● HPFEM	FE -Flat Ellipse	Mocha - S2005-Y	2000 x 1000mm	Lit Length = 4.1m
⊕ HPFECUS	FE -Flat Ellipse	Custom Paint	2000 x 1000mm	Lit Length = 4.1m

### Rectangle 2400x1200mm [Lighting L=6.0metres] 11.5Kg

○ HPRW	R - Rectangle	White - S0550N	2400 x 1200mm	Lit Length = 6.0m
● HPRC	R - Rectangle	Cream S1505-Y	2400 x 1200mm	Lit Length = 6.0m
● HPRM	R - Rectangle	Mocha - S2005-Y	2400 x 1200mm	Lit Length = 6.0m
⊕ HPRCUS	R - Rectangle	Custom Paint	2400 x 1200mm	Lit Length = 6.0m

### Square 1200x1200mm [Lighting L=3.6metres] 6.0Kg

○ HPSW	S - Square	White - S0550N	1200 x 1200mm	Lit Length = 3.6m
● HPSC	S - Square	Cream S1505-Y	1200 x 1200mm	Lit Length = 3.6m
● HPSCM	S - Square	Mocha - S2005-Y	1200 x 1200mm	Lit Length = 3.6m
⊕ HPSCUS	S - Square	Custom Paint	1200 x 1200mm	Lit Length = 3.6m

### Circles Ø \*1600, 1200 or 800mm

○ HPLCW	LC - *Large Circle	White - S0550N	OD = Ø1600mm	Lit Length = 4.08m
● HPLCC	LC - *Large Circle	Cream S1505-Y	OD = Ø1600mm	Lit Length = 4.08m
● HPLCM	LC - *Large Circle	Mocha - S2005-Y	OD = Ø1600mm	Lit Length = 4.08m
○ HPCW	C - Circle	White - S0550N	OD = Ø1200mm	Lit Length = 2.8m
● HPCC	C - Circle	Cream S1505-Y	OD = Ø1200mm	Lit Length = 2.8m
● HPCM	C - Circle	Mocha - S2005-Y	OD = Ø1200mm	Lit Length = 2.8m
○ HPSCW	SC - Small Circle	White - S0550N	OD = Ø800mm	Lit Length = 1.6m
● HPSCC	SC - Small Circle	Cream S1505-Y	OD = Ø800mm	Lit Length = 1.6m
● HPSCM	SC - Small Circle	Mocha - S2005-Y	OD = Ø800mm	Lit Length = 1.6m

### Plectrum 1416x1197mm [Lighting L=2.92metres] 5.0Kg

○ HPPW	P - Plectrum	White - S0550N	1416 x 1197mm	Lit Length = 2.92m
● HPPC	P - Plectrum	Cream S1505-Y	1416 x 1197mm	Lit Length = 2.92m
● HPPM	P - Plectrum	Mocha - S2005-Y	1416 x 1197mm	Lit Length = 2.92m
⊕ HPPCUS	P - Plectrum	Custom Paint	1416 x 1197mm	Lit Length = 2.92m

HEXAGONS, POLYGONS, TRIANGLES, CLOUDS, STARS, LOVE-HEARTS made to order.

# ACOUSTIC HALO-POD LED 230V

Select Pod shape

40mm Light-weight acoustic board

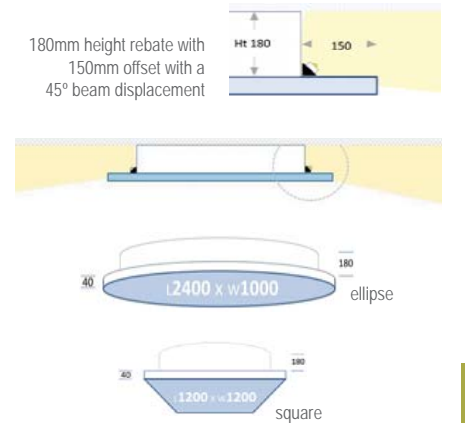

## Pod Colours

NCS National colours

White S 0500N

Cream S 1505Y

Mocha S 2005 -Y30R

Custom colours to order & volume.

Important Note : **LARGE CIRCLE Ø1600mm**  
 The Large Circle 1600mm is made in two parts and has a visible split line down the centre.

## How to Specify

- Select Shape & size on this Page 7, then go to select PowerLED's on Page 9 or SideLED Tape on Page 13 or mix and match.
- Add further feature lighting such as LED Fibreoptic Stars or LED spotlights on Page 15.



**ACOUSTIC HALO-POD LED 230V**  
**Select PowerLED Links**  
single colour & RGB full colour change

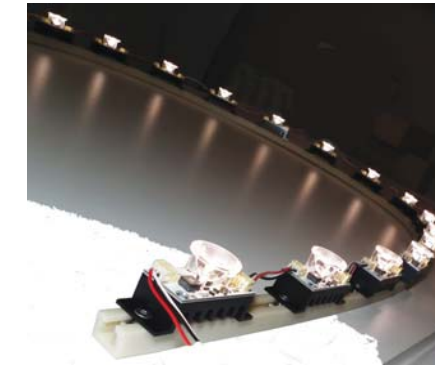

1.5Kg PowerLED Product Weight including Gear  
Kg max per linear metre lit length of PowerLED  
Add m/length to POD shape weight



**PowerLED Specification in Halo**

Halo-effect lighting in PowerLED provides performance lighting with light spreads beyond 2.0m visible. At Pitch 100mm it can provide up to 1,920lms / metre, some 3 - 4 times the light of most of the 'best' LED tapes. Powerful enough to be the main room ambient light source. Best suited at optimum capital cost at 200mm pitch at 960lms/metre for general use. Available in RGB option. For assistance please consult our technical department.

**PowerLED - 3W each unit link [ 765 - 2340lms/m ]**



IP20 link boards pre-assembled in a PVC channel mounted setback 150mm from the pod-perimeter. PowerLED SEOUL SEMICONDUCTORS Z5™ 3W PowerLED's available in 3 standard pitches 100mm, 150mm or 200mm, with or without optic accessories. Available in various Whites from 2700K - 5300K. Other single colours & use of optics - see postfix codes indicated below in accessories.



126°  
No Optic

**PowerLED Pitch 100mm : \*1,920lms 20W/metre [10 LEDs/m]**

P102.NO	Pitch 100mm	2700K - 51lms/W	20W -1,530lms/m	No Optic - 126°
P103.NO	Pitch 100mm	*3000K - 64lms/W	20W -1,920lms/m	No Optic - 126°
P104.NO	Pitch 100mm	4000K - 77lms/W	20W -2310lms/m	No Optic - 126°
P105.NO	Pitch 100mm	5300K - 78lms/W	20W -2340lms/m	No Optic - 127°
P10RGB.NO	Pitch 100mm	RGB - 20.0lms/W	53W -1,032lms/m	No Optic - 120°

**PowerLED Pitch 150mm : \*1,281lms 13.4W/metre [6.67LEDs/m]**

P152.NO	Pitch 150mm	2700K - 51lms/W	13.4W -1021lms/m	No Optic - 126°
P153.NO	Pitch 150mm	*3000K - 64lms/W	13.4W -1281lms/m	No Optic - 126°
P154.NO	Pitch 150mm	4000K - 77lms/W	13.4W -1541lms/m	No Optic - 126°
P155.NO	Pitch 150mm	5300K - 78lms/W	13.4W -1561lms/m	No Optic - 127°
P15RGB.NO	Pitch 150mm	RGB - 20.0lms/W	35.4W -696lms/m	No Optic - 120°

**PowerLED Pitch 200mm : \*960lms 10W/metre [5 LEDs/m]**

P202.NO	Pitch 200mm	2700K - 51lms/W	10W -765lms/m	No Optic - 126°
P203.NO	Pitch 200mm	*3000K - 64lms/W	10W -960lms/m	No Optic - 126°
P204.NO	Pitch 200mm	4000K - 77lms/W	10W -1155lms/m	No Optic - 126°
P205.NO	Pitch 200mm	5300K - 78lms/W	10W -1170lms/m	No Optic - 127°
P20RGB.NO	Pitch 200mm	RGB - 20.0lms/W	26.5W -516lms/m	No Optic - 120°

**Accessory Optics for PowerLEDs**

Various optics are available for PowerLED boards in Linear Wall Wash [ Elliptical 15x60°], Medium Wide - 40°, Medium - 25° & Narrow 10°. For perfect uniformity halo-effect is best achieved with no optics [ as codes above ]. Use at designer's discretion. Optics are removable or can be added later. Trichip LED RGB is suitable for use with Medium Wide 40° only.

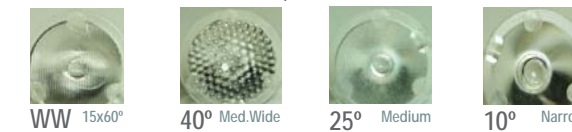

Wall Wash	15 x 60°	Elliptical	Substitute post-fix	WW
Medium Wide	40°	Brings in beam	Substitute post-fix	40
Medium	25°	Intensifies beam	Substitute post-fix	25
Narrow	10°	Focuses beam	Substitute post-fix	10

**Postfix code substitutions:**

Remove postfix ".NO" as above for No Optic and substitute for postfix codes shown below. For example: PL200-3.NO becomes PL200-3.WW when Wall Wash optic is used.

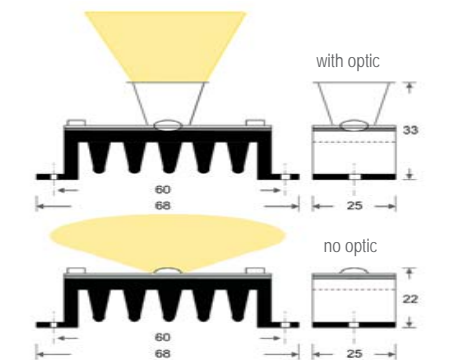

**PowerLED Colours**

- Extra Warm White - 2700K - CRI > 90%
- Warm White - 3000K - CRI > 90%
- Intmd White - 4000K - CRI > 85%
- Cool White - 5300K - CRI > 80%
- Royal Blue - 457nm
- Red - 625nm
- Green - 525nm
- Amber - 587nm
- RGB Colour Change



**How to Specify**

- Select Shape & size of Halo-pod on Page 7, then go to select PowerLED's on this Page 9 or SideTapeLED on Page 13 or mix and match.
- Add further feature lighting such as LED Fibreoptic Stars or LED spotlights on Page 15.







# CREATE YOUR OWN HALOPOD

..... design your own creations with our team .....

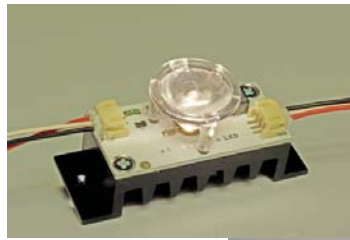

### Kelvin Control

- HALO-POD™ is available in White LED 2700K to 6500K.
- For creation of Dynamic White we can add to the designers brief 1, 2, 3 or more circuits of white single colours of varying Kelvin blending bespoke whites.
- We can create your halo specifications to suit your designs.

### Dynamic White

Dynamic white is useful for changing cool & warm white or the lights colour appearance in Kelvin temperature stops. [ Typically in the range of 2700K to 6500K Kelvin ]. Ideal for changing mood or ambience. Halopod simplifies DWCS by using 2 circuits dimmed. Further design and specification support is available from our technical dept.

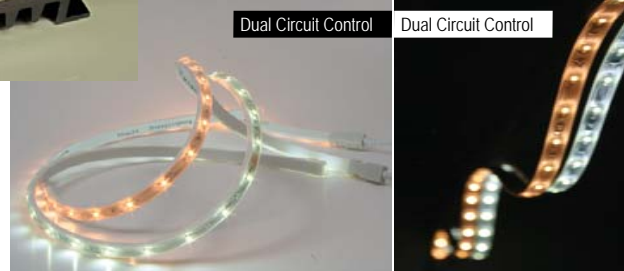

### Custom Shapes, Custom Features

On larger projects we can offer bespoke HALO-POD shapes, such as Hearts, Jig-Saw Puzzles, Crescent Moons, Stars etc. Or why not add some features that you like such as your own downlights, LED panels or surface projectors or more. The "Sky is your limit", unleash the creative genius inside of you ..... Further design and specification support is available from our technical dept. Other products are subject to surcharges, mark-ups and weight limitations, apply for costings and feasibility with our sales office.



### High level Architectural Control

- The HALO-POD concept is controllable using remote interfaces & standard protocol signals, including options for DMX 512, 0-10V or DALI.
- Due to varied and multiple gear options we offer detailed consultation to configure & quote accordingly to the end-user / design teams needs.
- Example circuit diagrams exist in our main catalogue.



**LED**  
DEDICATION

CONSTANT  
VOLTAGE

LINEAR LED LIGHTING - CONTINUOUS

## ACOUSTIC HALO-POD LED 230V

### Select LED Tape

single colour & RGB full colour change

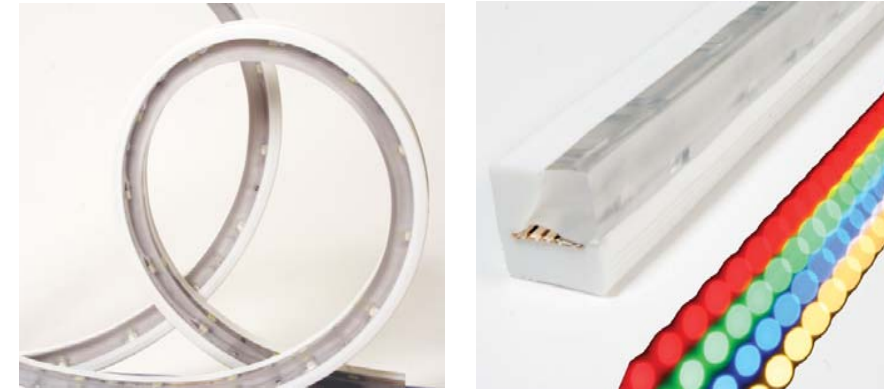

1 Kg  
Kg max per linear metre lit length of PowerLED  
Add m/length to POD shape weight

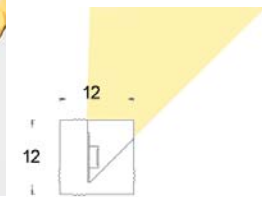

### SIDELED Tape specification in Halo

Halo-effect lighting in SideLED tape offers lower output - lower energy & reduced capital investment than PowerLED's with improved uniformity. The High Output [ HO ] version at pitch 8.33mm with up to a credible 562lms per meter can still offer performance ambient lighting and add to overall room lighting levels. Low Output [ LO ] Tape with a pitch 28mm with half the lumen output at should only be considered as effect lighting when a 350 - 500mm light throw or halo is required. RGB is offered with halo lighting throw's to 500 - 1000mm. Energy consumption is 25 to 50% less than PowerLED's. Uniformity with low pitch spacing is excellent. IP66 suitable for wet locations, bathrooms, Kitchens & humid areas.

#### SideLED Tape LO - Pitch 28mm [ 273lms/m version : 4.1 - 4.6W/m ]

Side emitting asymmetric LED Tape encapsulated to IP66. Medium Power SMD's using OSRAM Duris™ E5 version, typically 4.1W - 273lms per metre, Pitch 28mm [ To nearest 200mm ].

	<b>T282.S</b>	Extra Warm White	2700K - *59lms/W	4.6W/m - 273lm/m	No Optic - Asy40°
	<b>T283.S</b>	Warm White	3000K - *63lms/W	4.3W/m - 273lm/m	No Optic - Asy40°
	<b>T284.S</b>	Intmd. White	4000K - *66lms/W	4.1W/m - 273lm/m	No Optic - Asy40°
	<b>T285.S</b>	Cool White	6500K - *66lms/W	4.1W/m - 273lm/m	No Optic - Asy40°
	<b>TB.S</b>	Blue	460nm	0.8W/m - 13lm/m	No Optic - Asy40°
	<b>TR.S</b>	Red	620nm	3.3W/m - 36lm/m	No Optic - Asy40°
	<b>TG.S</b>	Green	530nm	2.5W/m - 111lm/m	No Optic - Asy40°
	<b>TA.S</b>	Amber	600nm	1.5W/m - 14lm/m	No Optic - Asy40°
	<b>TRGB.S</b>	RGB	DMX 512	6W	No Optic - Asy40°

#### SideLED Tape HO - Pitch 8.33mm [ 562lms/m version : 9.7W/m ]

Side emitting asymmetric LED Tape encapsulated to IP66. Medium Power SMD's using OSRAM Duris™ E3 version, 9.7W - 562lms per metre, Pitch 8.33mm [ To nearest 50mm ].

	<b>T82.S</b>	Extra Warm White	2700K - *57lms/W	9.7W/m - 562lm/m	No Optic - Asy40°
	<b>T83.S</b>	Warm White	3000K - *57lms/W	9.7W/m - 562lm/m	No Optic - Asy40°
	<b>T84.S</b>	Intmd. White	4000K - *57lms/W	9.7W/m - 562lm/m	No Optic - Asy40°
	<b>T85.S</b>	Cool White	6500K - *57lms/W	9.7W/m - 562lm/m	No Optic - Asy40°

#### Accessories for Dimming PowerLED & LED Tape

White & single LED's can be dimmed using integrated interfaces using signalling protocols in 0-10V, DALI or DMX. Just add accessory codes below. RGB circuits comes as standard with DMX interface.

##### 0-10V or DMX INTERFACE

0-10V or DMX dimming - matched in factory for use with 24V PSU. Preassembled and mounted within the Halo-pod. Simply state dimming via 0-10V or DMX and use code below as accessory.

**OLC.V110** Rated as 3 x 48W IP20 : 3 x 2Amp max 144W @ 24V 1-10V

**OLC.DMX** Rated as 3 x 48W IP20 : 3 x 2Amp max 144W @ 24V DMX

##### DALI INTERFACE

DALI dimming - matched in factory for use with 24V PSU. Preassembled and mounted within the Halo-pod. Simply state dimming via DALI and use code below as accessory.

**TLQ.CVDALI** Rated as 3 x 48W IP20 : 3 x 2Amp max 144W @ 24V DALI

#### TapeLED Colours

- Extra Warm White - 2700K - CRI > 90%
- Warm White - 3000K - CRI > 90%
- Intmd White - 4000K - CRI > 85%
- Cool White - 5300K - CRI > 80%
- Royal Blue - 469nm
- Red - 617nm
- Green - 525nm
- Amber - 587nm
- RGB Colour Change



#### How to Specify

- Select Shape & size of Halo-pod on Page 7, then go to select PowerLED's on Page 9 or SideTapeLED on this Page 13 or mix and match.
- Add further feature lighting such as LED Fibreoptic Stars or LED spotlights on Page 15.

## CUSTOM DESIGNS Specifications to Order



Custom Designs : Example



Add Fibre Optic Stars



Add Spotlights LED



**LED** DEDICATION  
CONSTANT VOLTAGE & CONSTANT CURRENT

LINEAR LED LIGHTING - CONTINUOUS

**ACOUSTIC HALO-POD LED 230V**  
Add Feature Lighting  
single colour & RGB full colour change



Add Fibre Optic Stars

Add Fibre Optic Stars in 20W LED light generator provides 140 points per set [qty x sizes : 100pcs x 0.75, 30pcs x 1.0, 10pcs x 1.5mm.]  
One set offers Single colour, White or RGB colour change with standard "twinkle effect" c/w remote control with flash, fade or jump. Order single or multiple sets for each Halo-pod integrated to order.



Add Spotlights LED

Add outline perimeter spots in 3W LED's in integrated downlights, fully adjustable tilt to 25° and beam angles in narrow 16° or medium 40°. See line drawings and codes for the number of spots for each Halo-po shape.  
Finished in Aluminium or White.  
Also custom arrays to order - please enquire.



Add Fibre Optic Stars [Twinkle]

Integrated 20W LED light generator & fibre optic stars capable of White, single static colours or full RGB sequencing colour change in one package. Twinkle & other modes as standard. Hand remote controller. Order as multiples of 1, 2 or 3 sets as listed below. Pre-wired & factory assembled for 1-stop site connection. Custom configurations on request. For DMX programmable systems add DMX to order code.



<b>FOS.1</b>	Fibre Stars - 1 set	20W : Integrated	100x0.75/30x1/10x1.5mm	RGB c/w Remote
<b>FOS.2</b>	Fibre Stars - 2 set	40W : Integrated	200x0.75/60x1/20x1.5mm	RGB c/w Remote
<b>FOS.3</b>	Fibre Stars - 3 set	60W : Integrated	300x0.75/90x1/40x1.5mm	RGB c/w Remote
<b>FOS.CUS</b>	Fibre Stars - Custom	TBA : Integrated	factory will refer to custom	RGB c/w Remote



Add Spotlights LED dimmable [perimeter layout as shown or custom]

Integrated 2W LED 3000K or 4000K recessed spot downlights in an array to suit each Halo-pod's shape outline. Pre-wired & factory assembled for 1-stop connection. Available in Narrow spot 16° or Medium 40° beams. Finished in White or Aluminium. Custom quantities & spacing configurations on request.



<b>SS3WH</b>	Spot - 16° narrow	2W : 3000K	Integrated	Finish - White
<b>SS3AH</b>	Spot - 16° narrow	2W : 3000K	Integrated	Finish - Aluminium
<b>SS4WH</b>	Medium - 40°	2W : 4000K	Integrated	Finish - White
<b>SS4AH</b>	Medium - 40°	2W : 4000K	Integrated	Finish - Aluminium

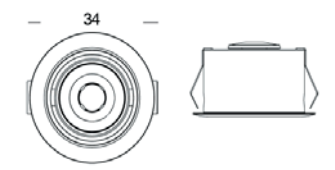

Nos of Spotlights

Ellipse 2400	=	10
flat Ellipse 2000	=	9
Rectangle 2400	=	12
Square 1200	=	8
Large Circle 1600	=	10
Std. Circle 1200	=	8
Small Circle 800	=	6
Plectrum 1416	=	6
Hexagon 1200	=	6
Triangle 1200	=	6

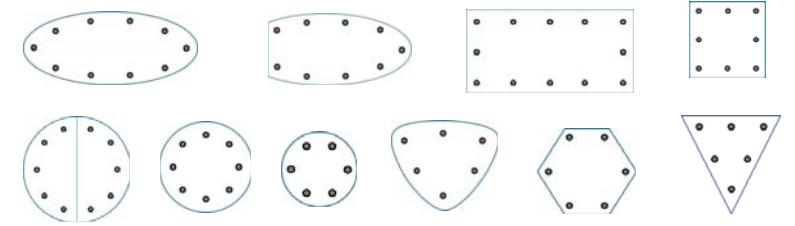

**How to Specify**

- Select Shape & size of Halo-pod on Page 7, then go to select PowerLED's on Page 9 or SideTapeLED on Page 13 or mix and match.
- Add further feature lighting such as LED Fibreoptic Stars or LED spotlights on this Page 15.



## Lighting Design, Layout & Illumination Guide

1) Select Shape, Size & Layout (refer to Page 7)  
Select the most appropriate shape and size of the Acoustic Halo-Pod required for the project.  
[ Standard shapes and size codes are given on Page 7.]

Guidance on Shape & illumination are as for point 2) below.

Please refer to our Sales Office for further information.

2) Shape & Illumination Levels (refer to Page 9 & 13)  
If selecting shape based on power illumination levels a comparison can be made in Tables 1.1, 1.2 & 2.1 opposite.  
Halo-Pod is available in a) PowerLED or b) SideLED Tape ;

- a) PowerLED**  
In 3 pitches; Pitch 100, 150 or 200mm
- PowerLED's are best used for functional lighting & best without optics in general halo use.
  - Close pitches of 150mm or less can be used to service higher ambient lighting levels.
  - Pitch 200mm affords optimum uniformity to capital cost ratio.
- b) SideLED Tape i**  
In High Output [ Pitch 8.33mm ] or Low Output [ Pitch 28mm ]
- High Output [HO] Pitch 8.33mm is best used for practical lighting levels.
  - Low Output [LO] Pitch 28mm is best used for decorative effect.

3) Add any Feature Lighting (refer Page 13)

- 3a) Fibre Optic Stars Halo-Pod** is offered as standard with the addition of Fibre Optic Stars
- 3b) Spotlight**  
Halo-Pod is offered as standard with the addition of recessed adjustable down spotlights.

Table 1.1 PowerLED Total Lumens by Halopod Shape

	Lit Length (M)	Archiled Boards [ pcs ]			Total Load [ W ]			3000K PowerLED Total Lumens [ lms ]		
		Pitch [mm]	Pitch [mm]	Pitch [mm]	Pitch [mm]	Pitch [mm]	Pitch [mm]	Pitch [mm]	Pitch [mm]	
Ellipse	4.68	23	31	46	69	93	138	3933	5301	7866
Flat Ellipse	4.1	20	27	41	60	81	123	3420	4617	7011
Rectangle	6	30	40	60	90	120	180	5130	6840	10260
Square	3.6	18	24	36	54	72	108	3078	4104	6156
Circle	2.8	14	18	28	42	54	84	2394	3078	4788
Large Circle	4.08	20	27	40	60	81	120	3420	4617	6840
Small Circle	1.57	7	10	15	21	30	45	1197	1710	2565
Plectrum	2.92	14	19	29	42	57	87	2394	3249	4959

Table 1.2 SideTape Total Lumens by Halopod Shape

	Lit Length (M)	Tape Length		Total Load [ W ]		3000K Side TapeLED Total Lumens [ lms ]	
		Pitch [mm]	Pitch [mm]	Pitch [mm]	Pitch [mm]	Pitch [mm]	Pitch [mm]
Ellipse	4.68	4.8	4.7	21	45.6	1310	2637
Flat Ellipse	4.1	4.2	4.1	18	39.8	1147	2300
Rectangle	6	6	6	26	58.2	1638	3366
Square	3.6	3.6	3.6	15	34.9	983	2020
Circle	2.8	2.8	2.8	12	27.2	764	1571
Large Circle	4.08	4.2	4.1	18	39.8	1147	2300
Small Circle	1.57	1.6	1.6	6.9	15.5	437	898
Plectrum	2.92	3	2.95	13	28.6	819	1655

Table 2.1 Lumens Per Metre Comparison

		3000K PowerLED Archiled Boards			3000K SideTape LED	
		Pitch [mm]			Pitch [mm]	
		200	150	100	DECO 28	HO 8.33
LED Power	W	3	3	3	0.12	0.08
LED's per Metre	pcs	5	6.7	10	35	120
Power / metre	W	15	20	30	4.6	9.7
Lumens / LED	lms	192	192	192	7.8	4.68
Lumens / W	lms / W	64	64	64	65	58.5
Lumens / metre	lms / m	960	1300	1920	273	562

## Mounting & Assembly Guide

a) Full Factory Assembly

The HALOPOD's are fully factory assembled off site and delivered and packaged for quick on-site installation. All gear and wiring looms are included and integral.

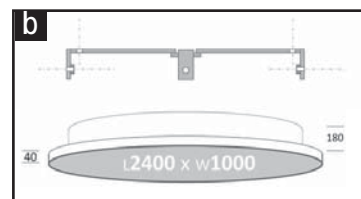

- b) Measure out the position of the Halopod on the ceiling.
- Dimensions are shown on page 7.
  - Full dimensional bracket & pod drawings, together with mounting instructions are available on request.
  - Use the actual mounting bracket as a template for marking out.
  - Attach the fast female socket cable connectors supplied to the pre-cabled wiring in the ceiling [ or wall ].

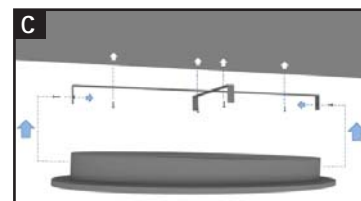

- c) Afix the bracket to the surface or ceiling with suitable screws or bolts. (not supplied).
- The pod has aligned bolt holes for fixing in two positions at each end of the pod to the mounting bracket.
  - The pod has fast connect male/female connectors for ready connection once lifted in to position.

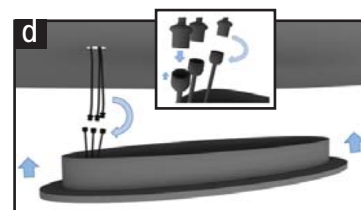

- d) Lift the pod : connect, afix and test.
- Use a two-man lift to align the pod to its bracket.
  - Once lifted in situ use a third person to assist with mating the male / female fast electrical connectors (colour coded).
  - Line up the bolt holes and afix the pod with the bolts.
  - Check the pod for correct alignment and close fitting with the ceiling or surface line. Adjust as necessary.
  - Check the pods functionality and switching.

## ACOUSTIC HALO-POD LED 230V control & switching

single colour & RGB full colour change

### ACCESSORIES

#### INTERFACES for Dimming PowerLED & SideLED Tape

White & single colour LED's can be dimmed using integrated interfaces using signalling protocols in 0-10V or DALI. Just add accessory codes below. RGB circuits come as standard with a DMX interface.

#### 0-10V or DMX INTERFACE

0-10V or DMX dimming - matched in factory for use with 24V PSU. Preassembled and mounted within the HALO-POD. Simply state dimming via 0-10V or DMX and use code below as accessory.

LC.V110	Rated as 3 x 48W	IP20 : 3 x 2Amp	max 144W @ 24V	1-10V
OLC.DMX	Rated as 3 x 48W	IP20 : 3 x 2Amp	max 144W @ 24V	DMX

#### DALI INTERFACE

DALI dimming - matched in factory for use with 24V PSU. Preassembled and mounted within the HALO-POD. Simply state dimming via DALI and use code below as accessory.

TLQ.CVDALI	Rated as 3 x 48W	IP20 : 3 x 2Amp	max 144W @ 24V	DALI
------------	------------------	-----------------	----------------	------

#### DRIVERS for Dimming Spotlights

Spot Downlight LED's can be dimmed using integrated interface drivers using signalling protocols in 0-10V or DALI . Just add accessory codes below for correct integrated driver. .

#### 0-10V DRIVER

0-10V dimming - matched in factory for use with 230V . Preassembled and mounted within the HALO-POD. Simply state dimming via 0-10V and use code below as accessory.

DR500.V110	min3 - max 14	IP20 : 500mA	L109x W50 x H35	1-10V signal
------------	---------------	--------------	-----------------	--------------

#### DALI DRIVER

DALI dimming - matched in factory for use with 230V. Preassembled and mounted within the HALO-POD. Simply state dimming via DALI and use code below as accessory.

DR500.DALI	min5 - max 14	IP20 : 500mA	L109x W50 x H35	DALI signal
------------	---------------	--------------	-----------------	-------------

#### SWITCH PLATES for Dimming & RGB Control PowerLED, SideLED Tape & Spotlights

White & single colour LED's can be switched using integrated interfaces using simple slide 1-10Vpotentiometer slide switch plates signalling protocols in 0-10V or DALI. Just add accessory codes below. RGB circuits come as standard with a DMX interface.

#### 0-10V SLIDE POTENTIOMETER SWITCH PLATE

Slide switch for 0-10V dimming - purpose switch for direct insertion in standard UK & European single-gang [ standard DIN & UK ] wall boxes [ minimum depth 35mm ]. Ideal for switching up to 10Amps [resistive] VAX loads. Available in 3 stock finishes, simply state White, Brass or Brushed Stainless Steel.

MAS.TK4.X	0-10V Slide dim	10Amp Potentio	L88 x H88 x D32	1-10V
-----------	-----------------	----------------	-----------------	-------

#### DIM TOUCH PAD SLIDE WHITE WHEEL or DWCS

White wheel touch pad [ WWTP ] c/w slide dimming. [ Can also be used with DWCS circuits as Dynamic White Control]. For 24Vdc connection and loads max.288W.

CWTP.MONO-D	Mono-Slide Dim	Double-Gang	max 288W @ 24V	Touch Dim
CWTP.MONO-S	Mono-Slide DIM	Single-Gang	max 144W @ 24V	Touch Dim

#### RGB TOUCH PAD COLOUR WHEEL

A colour wheel touch pad [ CWTP ] c/w slide dimming for use with full RGB control. For 24Vdc powering & connection and loads max.288W at 24Vdc or 3 x 4Amps. Any static colour on Wheel plus 19 dynamic mode options, 20 static cycle options, 26 brightness values & 26 speeds. Just add accessory codes below. [ For programmable RGB control use DMX channels or Colourwave controller below ].

CWTP.RGB	Colour Wheel+Dim	Double-Gang	max 288W @ 24V	Touch Scroll
----------	------------------	-------------	----------------	--------------

#### COLOURWAVE DMX CONTROLLER - DMX generator

A DMX signal generator with combined switch plate for mounting in double-gang switch / socket outlets - the ideal simple fully programmable stand-alone DMX solution. Supplied with remote 15Vdc 0.3A Power supply plug. 2 DMX universes, with standard scroll wheel for easy access of the 25 most used colours, as well as 7 cascading colour sequences, speed control and a simple save favourites menu. Signal only with no load passing restraint. The fully programmable solution for full RGB control.

MAS.CW.DMX	2 Universes	Double-Gang	no max Signal only	Programmable
------------	-------------	-------------	--------------------	--------------

#### FIBRE-OPTIC STARS for Star Twinkle, Dimming & RGB Control

The Fibre-optic Star extra option comes complete with its own 20W LED generator and fully integrated control for dimming levels & twinkle modes. For use with White and RGB control via a hand-held remote control. Pre-wired & factory assembled for 1-stop site connection. Custom configurations and integration with other on-site control systems on request. For Fibre-optic use with DMX please contact our technical or sales office.



Strategic Lighting and its affiliated group brands work diligently to conform with standards. This leaflet, its representative products and general descriptions are correct at the time of going to press. The Strategic Lighting Group and its affiliated brands reserve the right to continue with its product programme including amendments to product construction, materials and dimensions where appropriate. Always contact our on-line services, information and advice for the latest data at the time of specification. Some photographs, products, images and perspectives used in this publication are not real installations and may have been adopted, changed or subject to image alteration so as to present the product in its correct application. This is, in no way, intended to misrepresent the product or mislead the designer. Use at discretion of sample and sales office guidance. Thank you for your valued specifications.

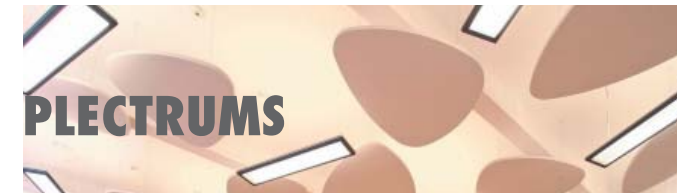

**2015 - 2016 DESIGNER GUIDE PRICES**  
**GBP £ / Shape**

The prices tabulated below are for indicative budget purposes only. They show complete fitted products, fully assembled, including integral gear in the different LED formats, as well as the over-cost for installed fibre optics & spotlights. They are intended for guide purposes and do not substitute project by project prices & quotations.

	PowerLED White Archiled Prices £			Side TapeLED White Prices £		PowerLED RGB Archiled Prices £			Side TapeLED RGB Prices £	Add Dimming Prices £	Add Stars Prices £	Add Spots Prices £
	Pitch [mm]			LO	HO	Pitch [mm]			Pitch [mm]			
	200	150	100	28	8.3	200	150	100	28			
Ellipse	£2,000	£2,200	£2,700	£1,550	£1,800	£2,850	£3,300	£4,200	£1,850	+ £150	+ £650	+ £1,100
Flat Ellipse	£2,150	£2,350	£2,900	£1,550	£1,800	£2,700	£3,100	£3,950	£1,850	+ £150	+ £650	+ £1,000
Rectangle	£2,050	£2,350	£2,950	£1,500	£1,850	£3,100	£3,750	£4,900	£1,850	+ £150	+ £350	+ £1,300
Square	£1,250	£1,550	£1,850	£950	£1,150	£1,950	£2,300	£3,000	£1,200	+ £150	+ £350	+ £900
Circle	£1,300	£1,450	£1,750	£1,050	£1,150	£1,850	£2,150	£2,650	£1,300	+ £150	+ £350	+ £900
Large Circle	£2,450	£2,650	£3,100	£2,100	£2,300	£3,200	£3,600	£4,400	£2,350	+ £150	+ £650	+ £1,100
Small Circle	£950	£1,050	£1,200	£800	£900	£1,350	£1,500	£1,800	£1,050	+ £150	+ £350	+ £700
Plectrum	£1,550	£1,700	£2,000	£1,250	£1,400	£2,100	£2,400	£2,950	£1,500	+ £150	+ £350	+ £700